

- Key:**
- Existing Assets
 - Water Main
 - HP Gas Main
 - Hedges & Trees
 - Proposed Assets:
 - Proposed 132kV Cable
 - Fibre Optic Cable
 - Proposed Trial hole
 - Trial Hole 3

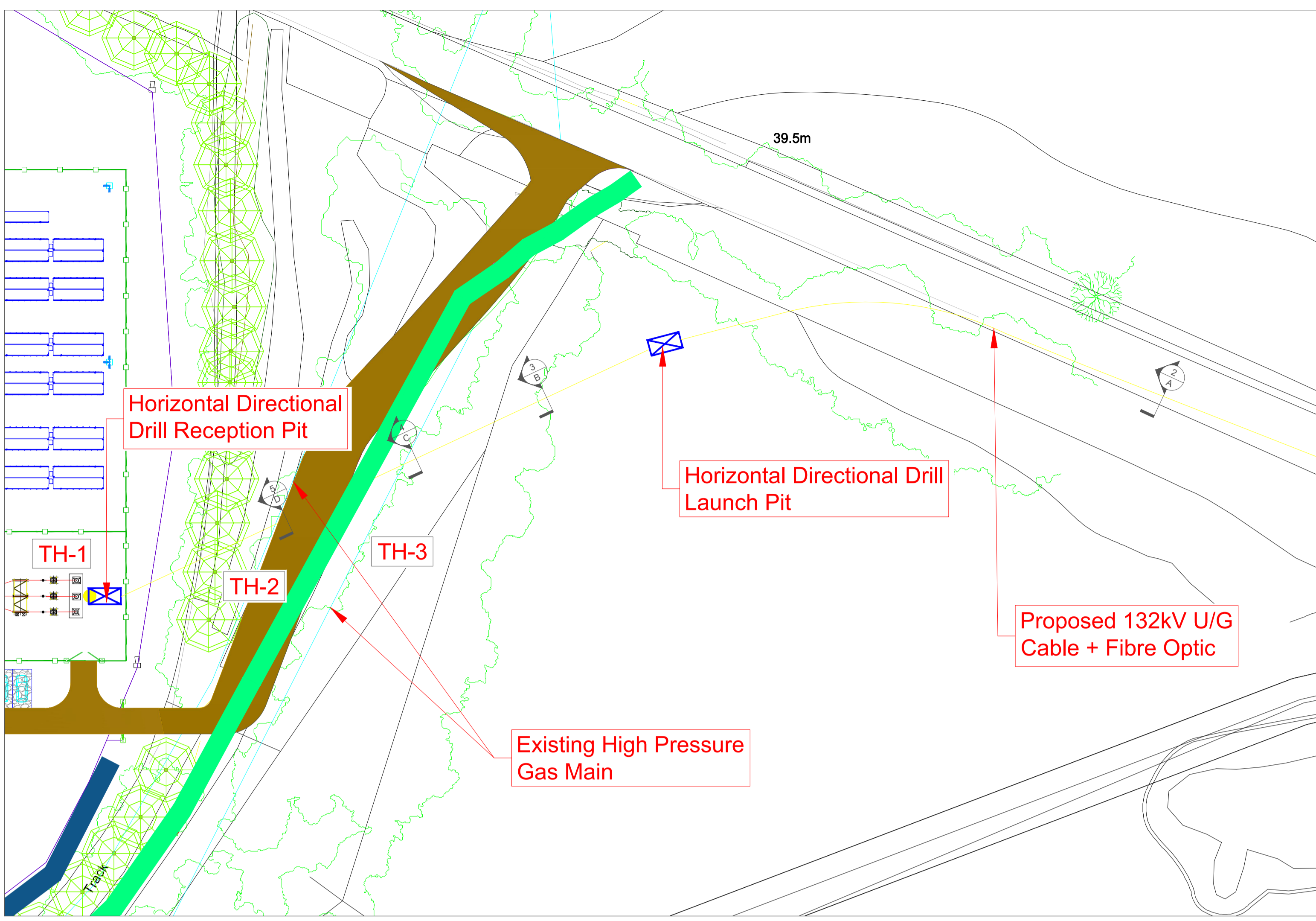

1 132kV CABLE ROUTE AT HDD LOCATION
Scale: 1:500 @ A1 1:1000 @ A3

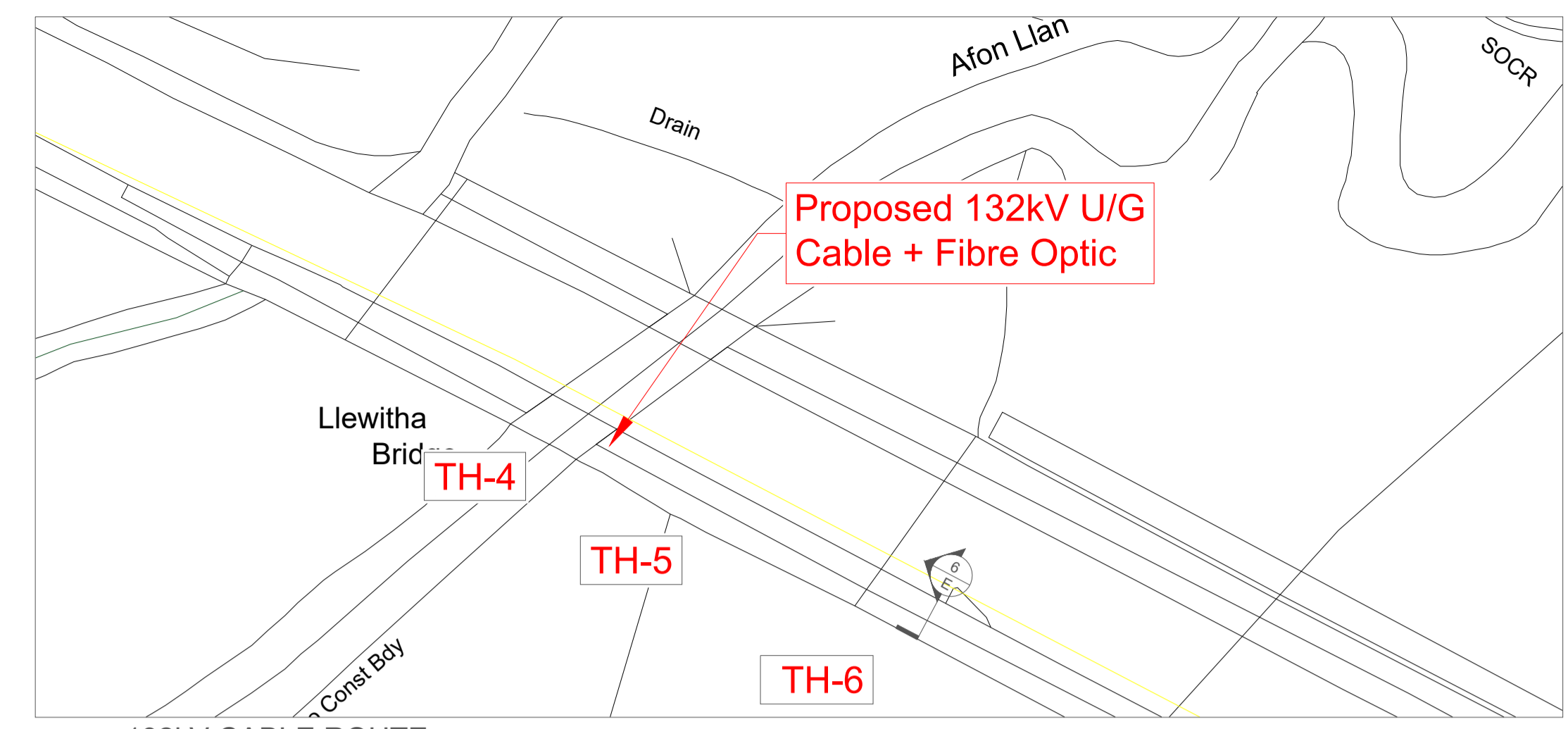

8 132kV CABLE ROUTE
Scale: 1:500 @ A1 1:1000 @ A3

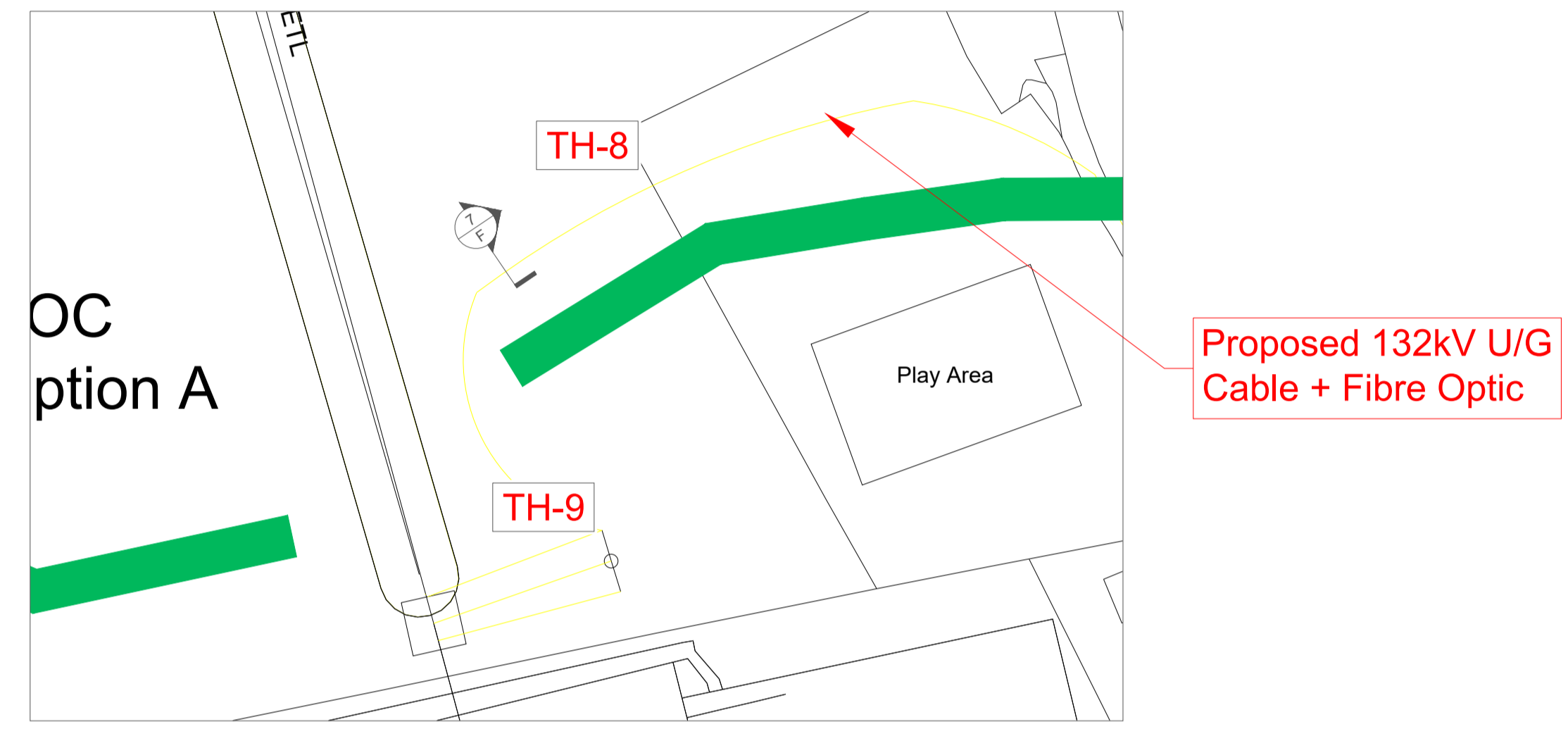

9 132kV CABLE ROUTE
Scale: 1:500 @ A1 1:1000 @ A3

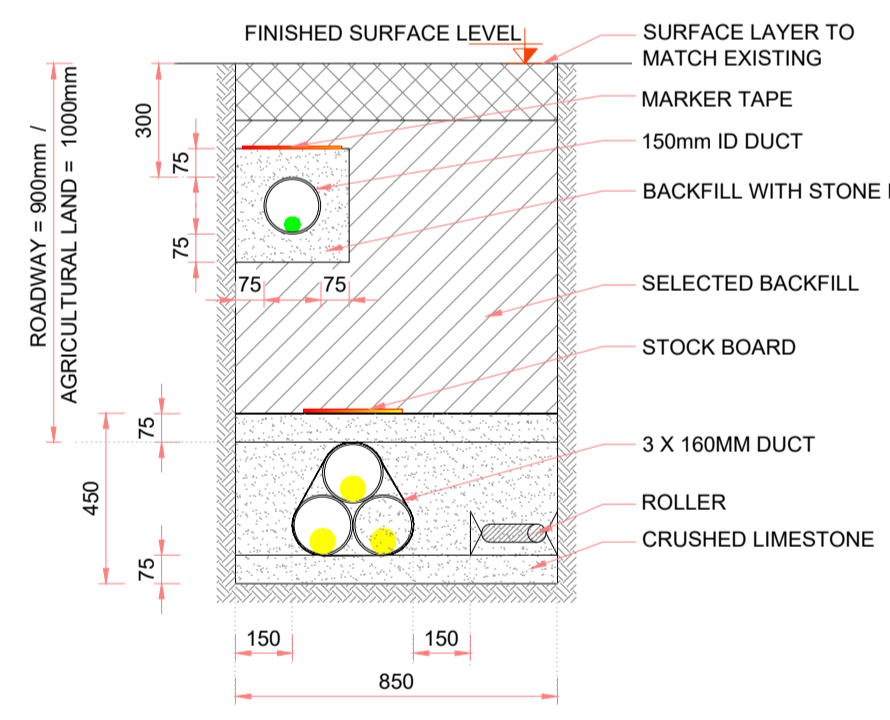

2 132kV CABLE TRENCH SECTION A-A
Scale: 1:20 @ A1 1:40 @ A3

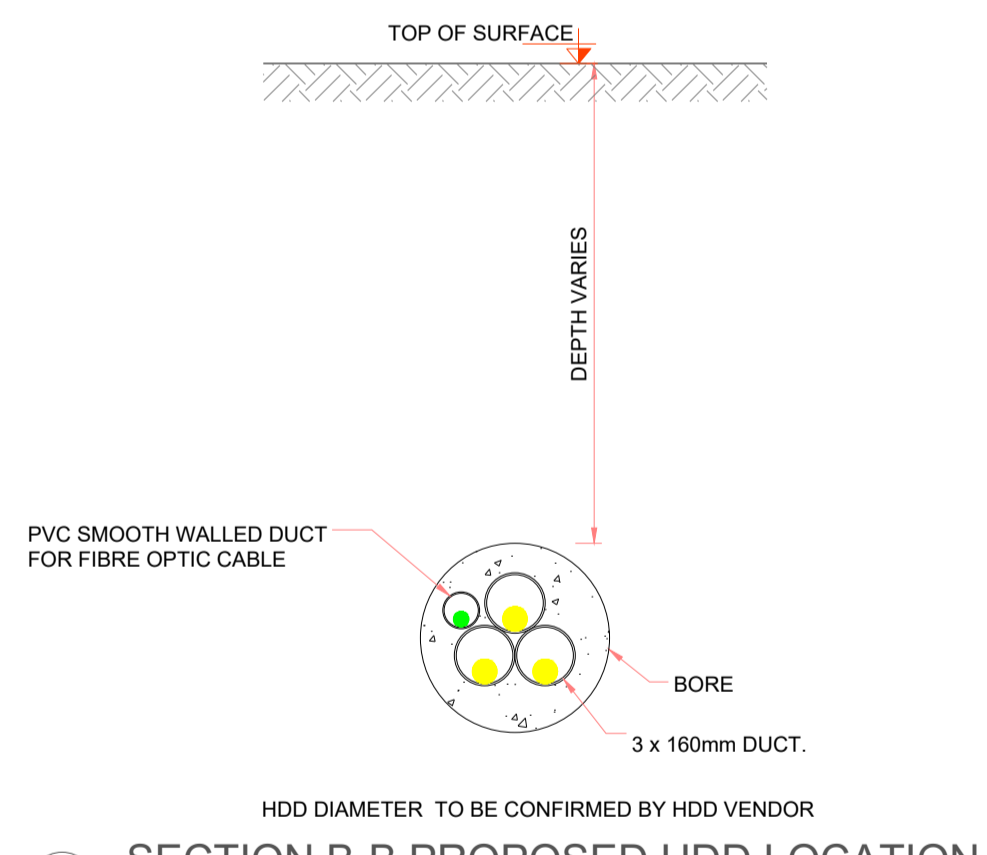

3 SECTION B-B PROPOSED HDD LOCATION
Scale: NTS

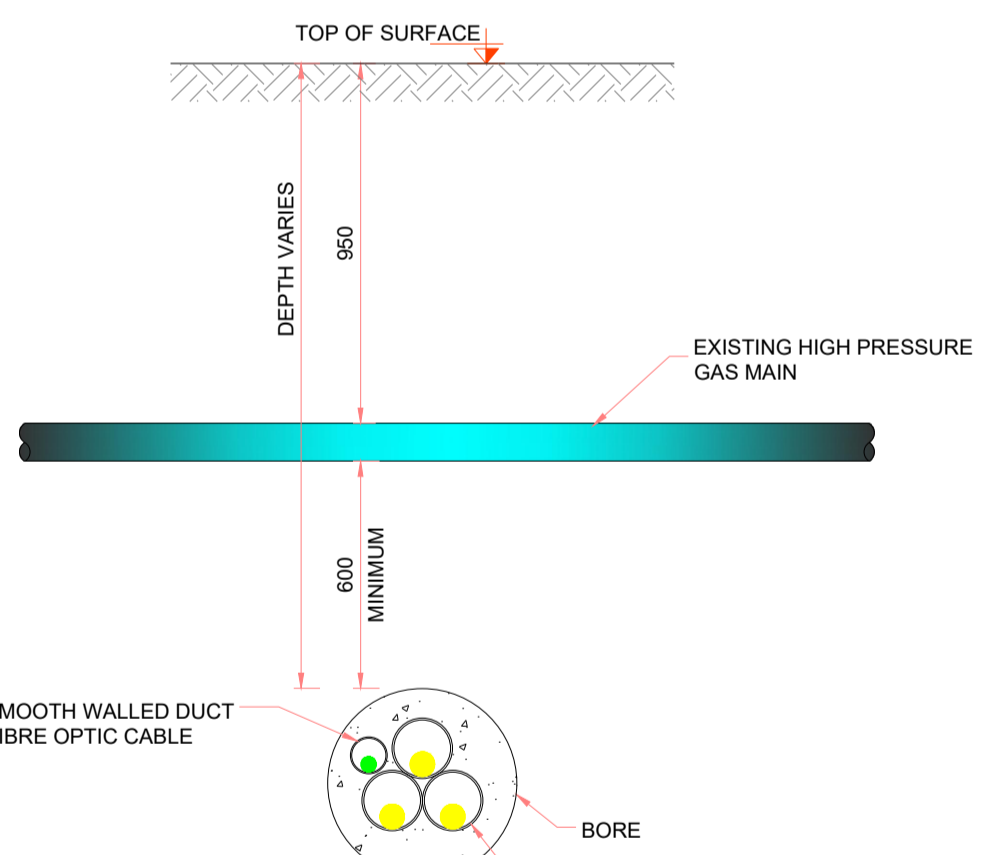

4 SECTION C-C
Scale: NTS

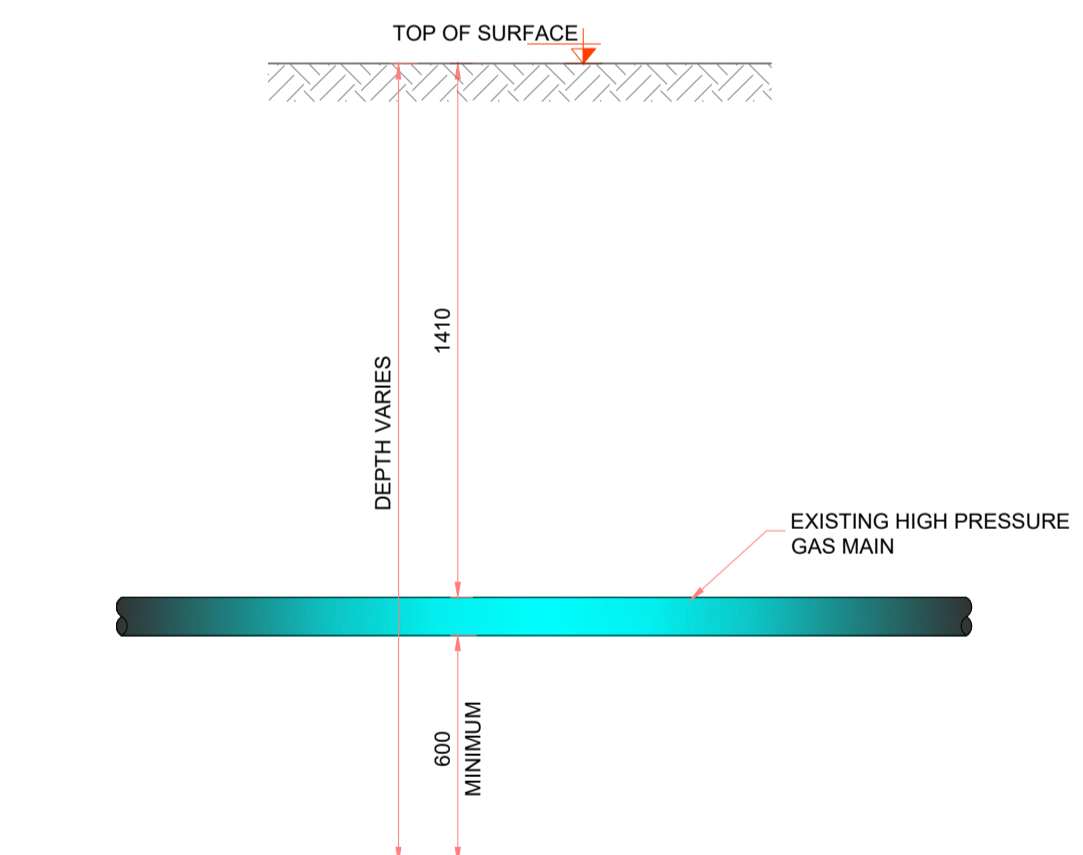

5 SECTION D-D
Scale: NTS

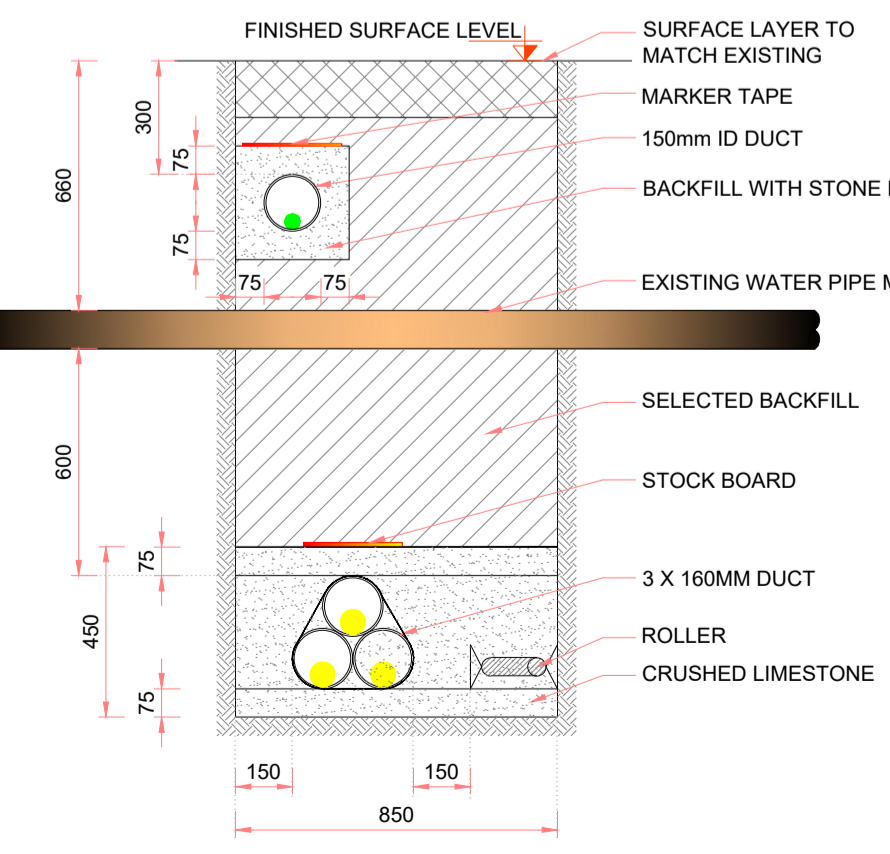

6 TRENCH SECTION E-E
Scale: 1:20 @ A1 1:40 @ A3

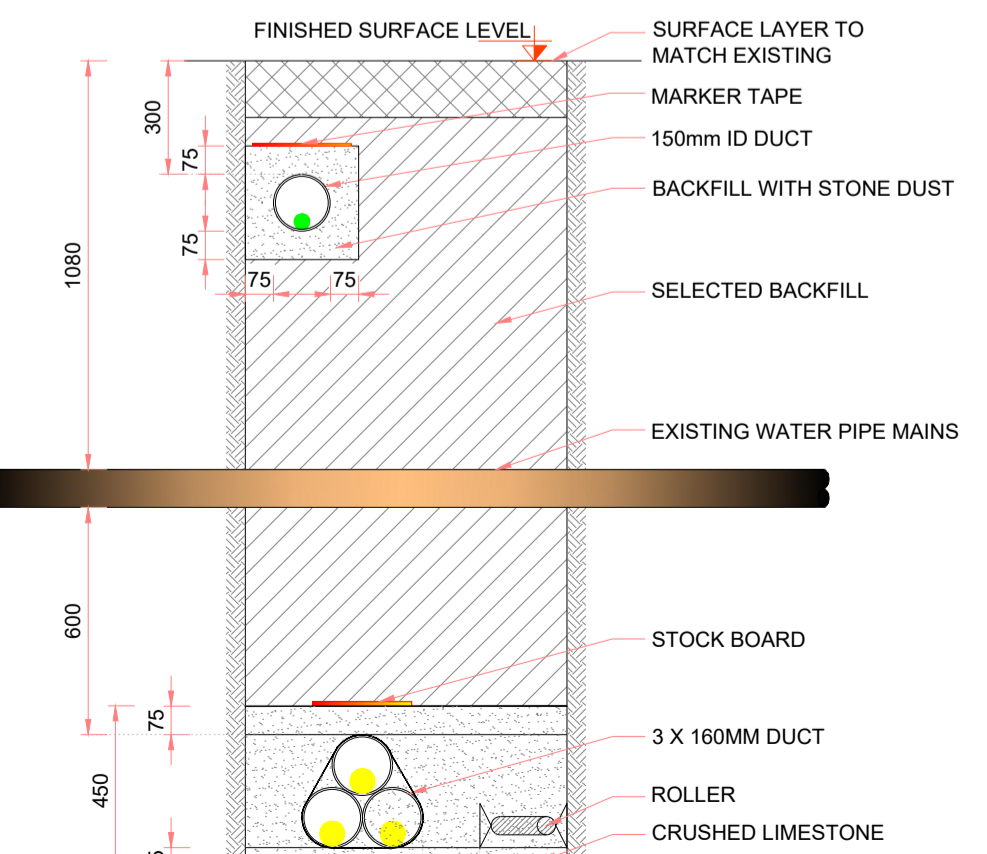

7 TRENCH SECTION F-F
Scale: 1:20 @ A1 1:40 @ A3

Site Address : Gowerton Solar PV & BESS,
Swansea Road, Goreinon,
Swansea, South Wales
Site Postcode: SA4 4LE

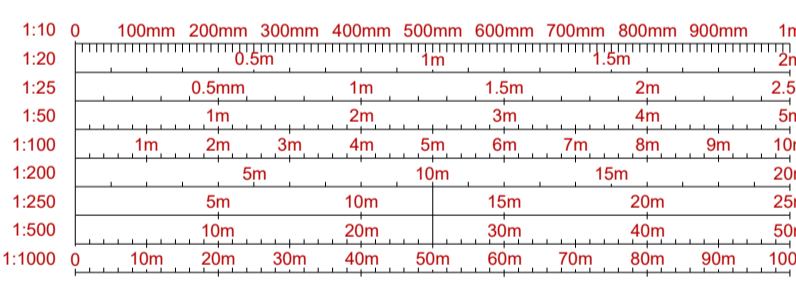

Issue	Date	Purpose of Issue	Drawn	Checked
4.0	03.06.2024	Amended Access Route	GR	GR
3.0	19.12.2023	Trench Sections Amended	SR	SF
2.0	11.12.2023	Amended as per Comments	SR	SF
1.0	06.12.2023	For Information	SR	SF



Suite 5, Exchange Station, Tithebarn St, Liverpool, L2 2QP

Client:
Low Carbon Alliance

Drawing Title:
132kV Cable Route Trench Sections

Drawn: GR	Date: 03.06.2024	Checked: CD	Date: 03.06.2024
Project Title: Gowerton		Scale: As Shown @ A1	
Job Ref: SC PJ 55 02		Page Number: 1 of 1	
Drawing Number: SC PJ 55 02-150-31		Issue 4.0	

